

## Bolt Ramp Fitting

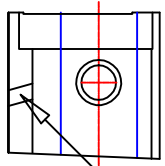

Note! Ramp of Guide Has Compound Angle.  
Bolt Ramp Must Match This Compound Angle.  
Correct For All Calibers

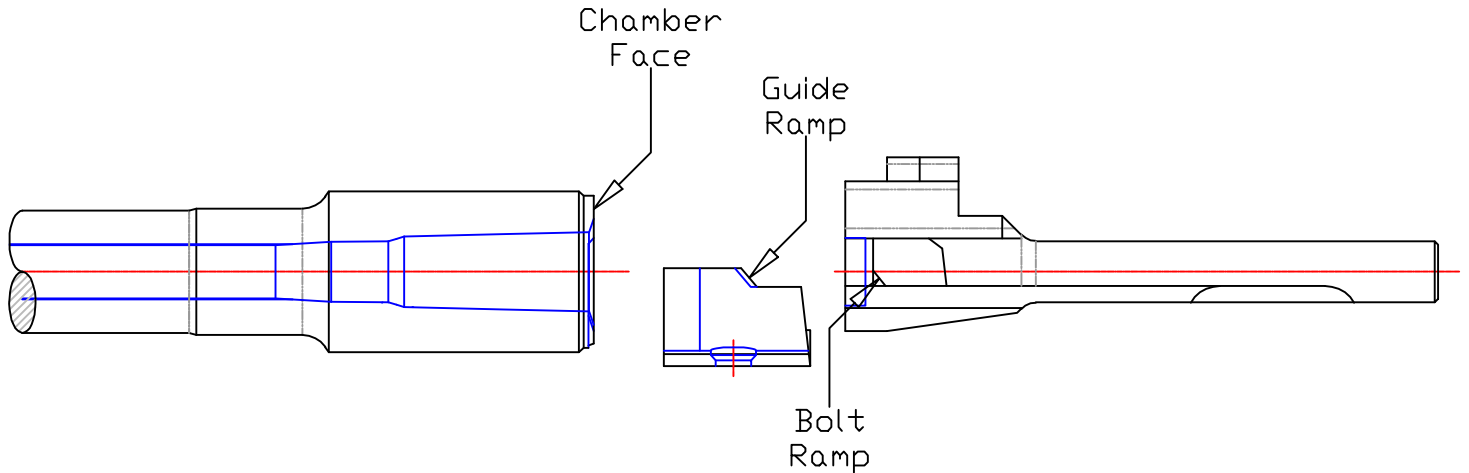

Insert 2,5mm Thick Gauge Between Bolt Face And Chamber Face.  
Move Bolt Forward Making Sure It Is Straight  
Ramps Can Contact Each Other But Bolt Must Not Turn

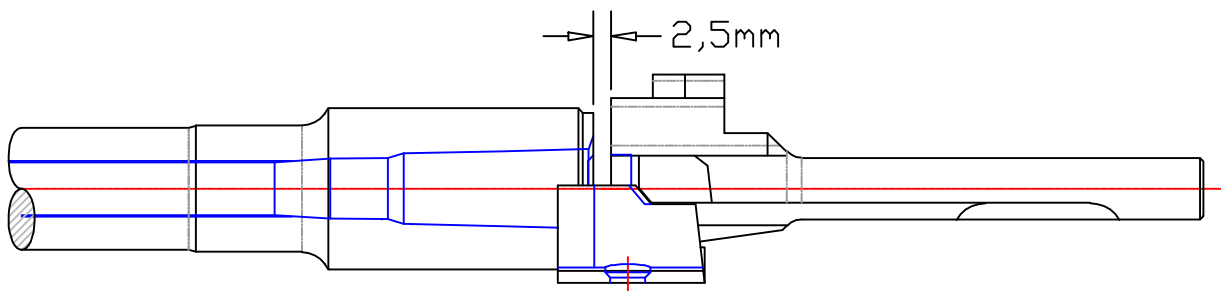

Insert 2,0mm Thick Gauge Between Bolt Face And Chamber Face.  
Move Bolt Forward Making Sure It Is Straight.  
Ramps Must Contact Each Other And Bolt Should Start Turn

