

Ing. Robert Forbus

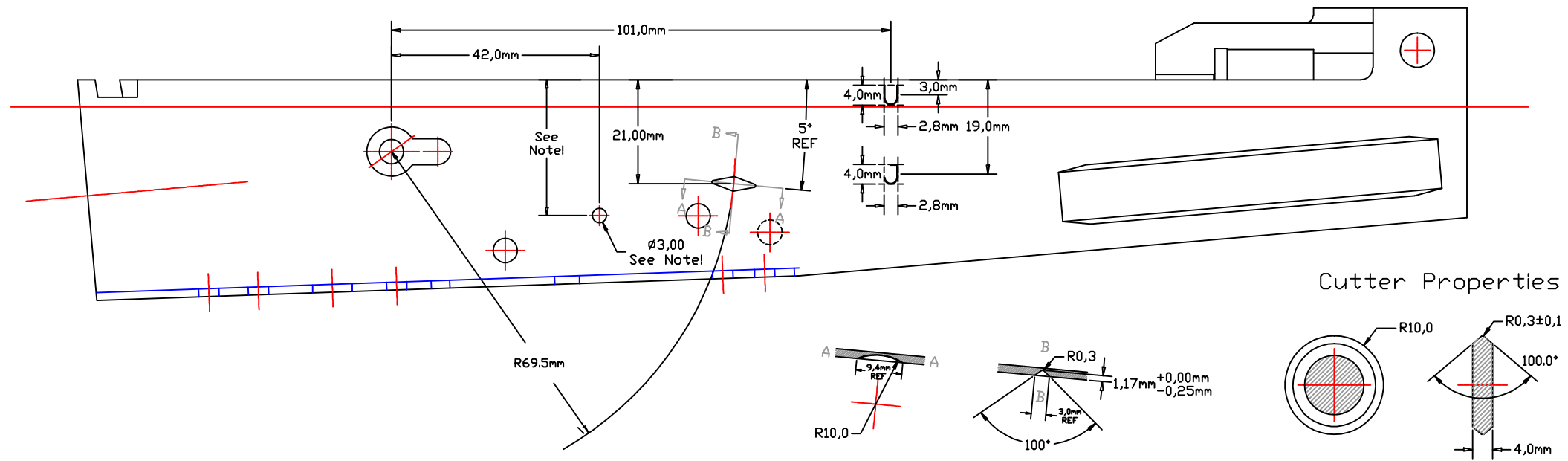

Cutter Properties

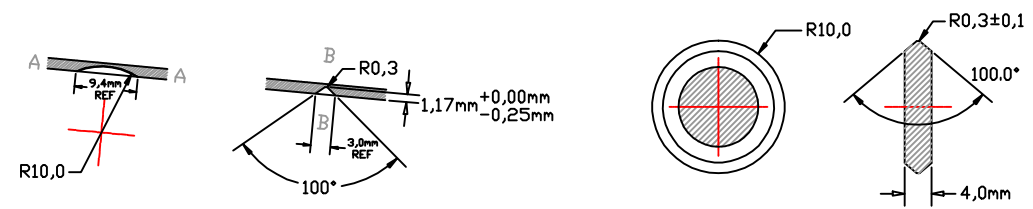

Note!
 $\varnothing 3,00\text{mm}$ Hole Is Placed After Selector Is Fitted.
 Center Of Hole Is 2,25mm From Lower Edge Of Selector

Protruding Section Is $\varnothing 4,0\text{mm}$. Allow Minimum 0,3mm Clearance Between Edge Of Selector And Pin

(Usage Area)		(Tolerance Permissible)	(Surface Area)	Scale 1:1	(Weight)
				(Material, Semifinish) (Slug Number) (Model Or Die Number)	
		Date	Name	M76 Receiver Side Finishing Details	
		Edit Editor	NAME		
		Proof Stamp	NAME		
		Norm			
				M76-0002	Sheet
					Bl.
Zust	Änderung	Date	Name (Urspr.)	(Ers. f.:)	(Ers. d.):